

Turning Your System On and Off

The On/Off button is located on the back panel.

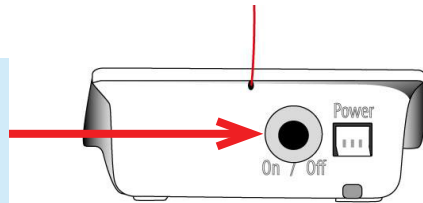

- To turn your system **OFF** press and hold for 4 beeps and it will switch off.
- To turn the system **ON**, press and hold until the green **ON** light indicates that the unit has started.

Please note: When the system is turned OFF and there is NO Green ON light, then your system will not operate.

Important Notes

Due to external factors it is possible that in exceptional circumstances the system may not operate as expected. Such factors include the telephone line being unavailable, radio interference, lightning strikes or network outages. These are rare events but because they are outside our control, we cannot accept any responsibility for damages or other consequences resulting from any failure.

If you suspect your system is damaged or not functional, please contact: **Securely on 0800 865 865**

EVE 3GD User Guide

Your new EVE personal response system contains the latest 3G technology to give you independence, peace of mind, and put you in contact with people who are there to help you.

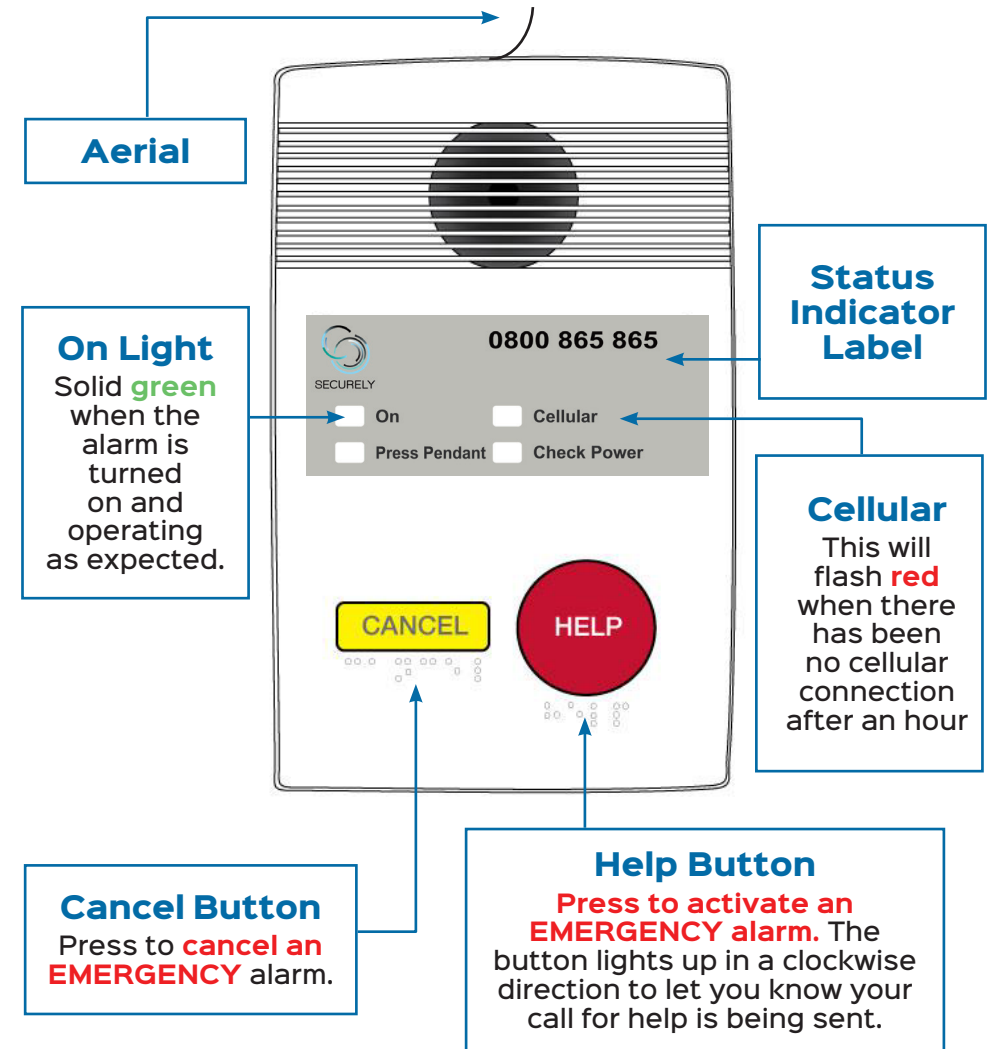

Your Personal Pendant

Your personal pendant should be worn at all times including at night in bed. It is waterproof and should be worn in the bath or shower.



Requesting Help

If you need help at any time of the day or night, press and hold the button on your personal pendant and count to three.

The outer rim will then illuminate and flash red to let you know your call for help is being sent. Alternatively press the large **HELP** button on the system.

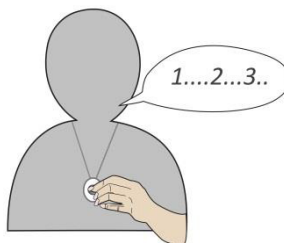

Talking to your Securely Operator

If you request help, you will hear a loud fifteen second alarm and your system will connect to Securely. When you hear the Securely operator you can communicate with them by speaking to the system.



Cancelling an Alarm

During the loud fifteen second alarm period you can cancel the alarm by pressing the **CANCEL** button.

For assistance call Securely on 0800 865 865

Care of your Pendant

AVOID direct spraying with perfume, insect repellent or similar chemicals, by holding it out of the way.

CLEAN with non-abrasive and non-polishing cleaners only.

RECOMMENDED a warm damp cloth is usually sufficient.

Front Label - Status Indicators

 **On** - this continuous **Green** light indicates that the base unit is on. It will flash when other errors are shown.

 **Cellular** - this will flash **Red** when there has been no cellular connection after an hour. In normal operating mode this light will be off.

 **Press Pendant** - this will flash **Blue** to let you know the pendant is due for testing. Please follow the '**Testing your System**' instruction below.

 **Check Power** - this will flash **Red** when there is a problem with the power connection and it needs to be checked. An audible message will play as well.

Testing your System

From time to time your system will request that you test it.

The '**Press Pendant**' indicator will flash **Blue**. Press and hold your pendant button and count to three. Wait to speak to an operator. Tell them you are testing.